



MODEL 5650 MASONRY WALL - DAMPER CASING - UNDER SLAB - DETAIL

Masonry Wall - Damper Casing - Under Slab - Detail

Drawing 5650-4

INSTALLATION INSTRUCTIONS

FRL - / 240 / -

- 1. INITIAL DAMPER TEST** Before installing damper into the wall, check damper's closing operation. This can be achieved by placing the damper in the upright position. Hold the blade whilst removing the UL33 rated fusible link. Let the blade fall. Gather blades up and return fusible link to its original position.
- Ensure that wall penetration is correct size. Opening should be larger than nominal size in both width & height. Refer AS1682.2-1990 Appendix 'C'.
- Remove flange screws/bolts and detach flanges from damper casing.
- Wrap damper with suitable insulation and slide into wall penetration.
NOTE: Dampers are clearly labelled with "AIRFLOW" direction and "TOP" of unit.
- Pack suitable insulation in any space between damper casing and penetration. Refer AS1682.2-1990 Clause 5-6.
- Replace flanges making sure damper is fixed firmly within the wall, use only sides and bottom flanges.
- Repeat INITIAL DAMPER TEST Point #1
- Connect ductwork to fire damper using fire resistant mastic to fill recess if using raw edge connection, or apply mastic to both surfaces of the TDF/TDC flange connections. (Bolts must be of a low melting point material).

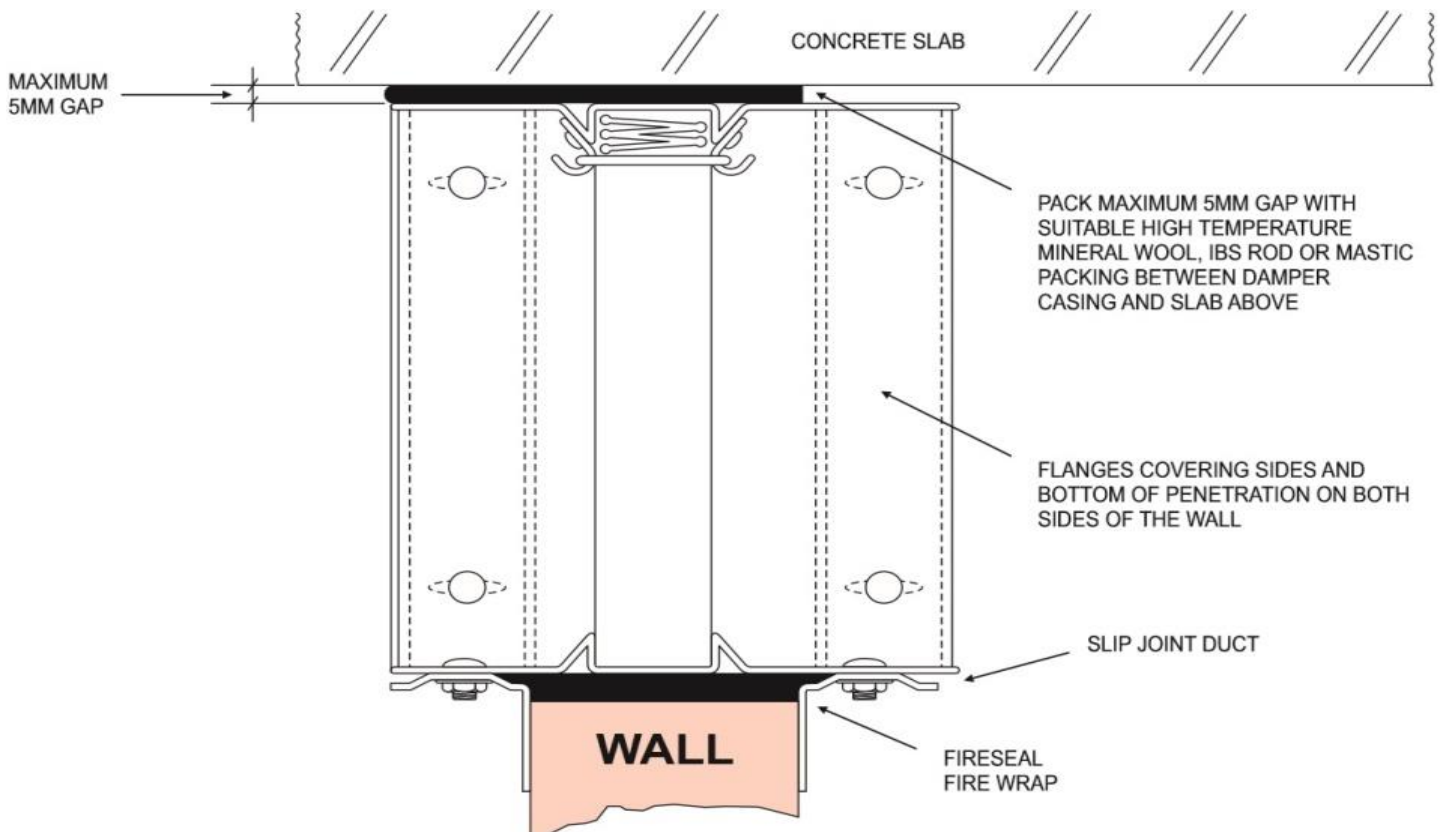

MAINTENANCE INSTRUCTIONS

All Fire Dampers shall be accessible and maintained in accordance with AS1851.6

Your local representatives details can be located at www.bullockmfg.com.au

