



MODEL 4800 MULTI-BLADE FIRE DAMPER

PRODUCTION DESCRIPTION

The Model 4800 Multi-blade type fire damper is designed to stop materials of combustion (fire) passing through air-conditioning and ventilation systems which penetrate fire rated masonry walls or concrete slabs

This model complies with AS1668.1 and AS1682.1 and has been certified by the C.S.I.R.O for a 4 hour fire rating (FRL).



Model 4800/s multi-blade slab type damper with patented 4hr FRL blade supports

MODEL FEATURES

- Australian certified to AS1530.4-1997 by C.S.I.R.O. in:
 - a) Masonry wall for 4 hour FRL - Sponsored investigation #-569
 - b) Concrete slab for 4 hour FRL - Sponsored investigation #-855
- All galvanised steel construction or stainless steel construction complying with AS1682.1
- Single use brass link 68 degree celsius
- High yield stainless springs with blade pivots
- Brass blade bushes
- Metal Gap Spacers allow the damper to be installed insitu with a factory controlled expansion gap (AS1682.2-1990.) This means no added installation or inspection coast plus the elimination of health hazardous high temperature fibre wraps. (Australian patent #624288.)
- **Optional** Channel flanges compatible with market available TDF, TDC, Englemate or Duct-mate duct flanging systems in sizes 25mm, 35mm or 50mm profiles.
(Note: Bolts are to be made of a low melting point material.)
- Manufactured sizes available from:
 - Wall:** 150mm x 150mm up to 2745mm x 2440mm
 - Slab:** 150mm x 150mm up to 2900mm x 1830mm
 - Round:** 150mm diameter up to 1200mm diameter



Blade linkages

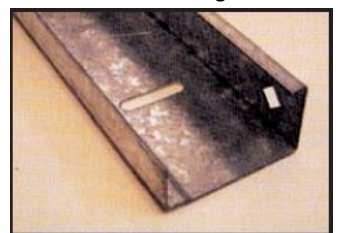

Flange Channels

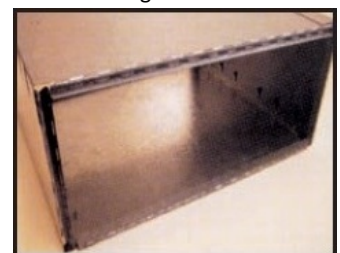

Metal Gap Spacers

Your local representatives details can be located at www.bullockmfg.com.au





MODEL 4800 MULTI-BLADE FIRE DAMPER

WALL MODELS AVAILABLE

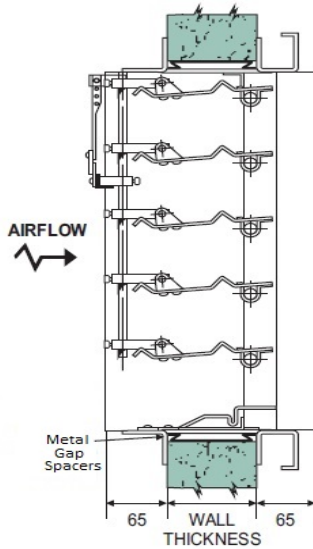

D-TYPE 1
DUCT to DUCT
Minimum 110mm Wall

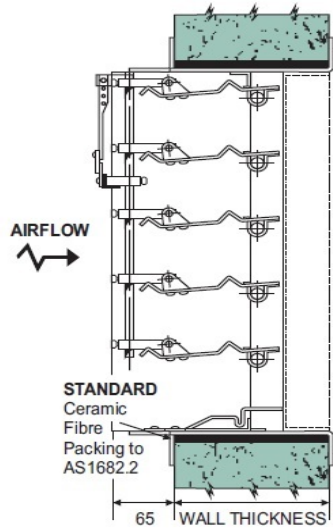

GS-TYPE 2
DUCT to GRILLE
Minimum 110mm Wall

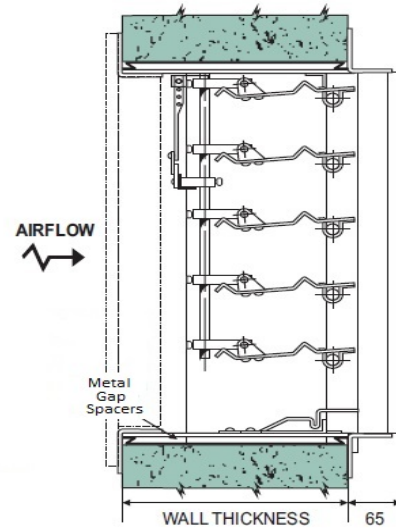

GR-TYPE 3
GRILLE to DUCT
Minimum 240mm Wall
ENERGY AUST. MODEL

TYPICAL SPECIFICATION

"Openings in fire rated walls or slabs shall be protected by a Bullock Model 4800 multi-blade fire damper or approved equivalent. Dampers shall be provided where shown on drawings or wherever required to meet local regulations and must comply with AS1682.1 and AS1668.1-1998.

Dampers shall be installed in strict accordance with the manufacturer's installation instructions, to comply with certificates of test furnished by the manufacturer.

The damper's construction must be in compliance with the tested prototype. The body being made with galvanise steel and any exposed welds to be coated with cold zinc primer type paint to prevent rusting. The damper body must be design engineered for strength and rigidity to reduce the chances of operational damage during transport and/or site installation.

The damper's expansion gap shall be constantly maintained with the use of Bullock's **Metal Gap Spacer system**, complying with AS1682.1 or approved method. Fusible links are to operate at 680 Degree C., or have an AS1890 rating."

SLAB MODELS AVAILABLE

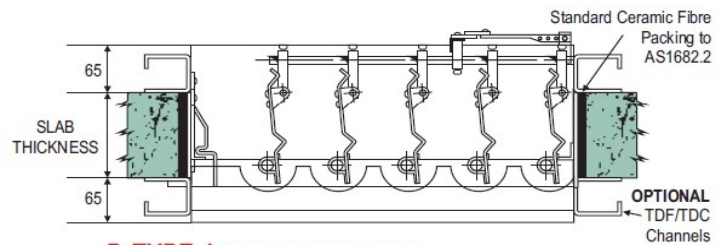

D-TYPE 4 Minimum 100mm Slab

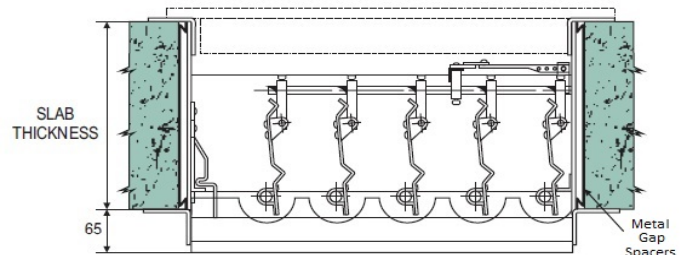

GS-TYPE 5 Minimum 260mm Slab

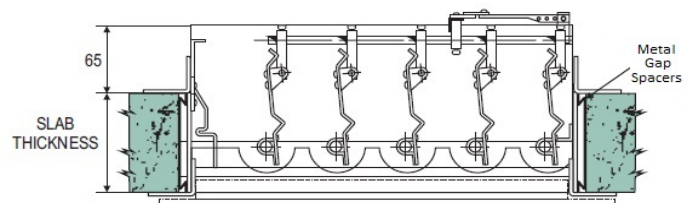

GR-TYPE 6 Minimum 100mm Slab

Your local representatives details can be located at www.bullockmfg.com.au

